

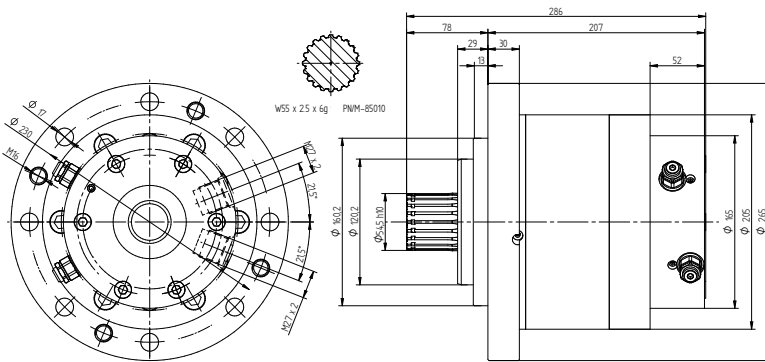

SATELLITE MOTOR P+SM 2,1/80

TECHNICAL CHARACTERISTICS OF HYDRAULIC MOTOR TYPE P+SM 2,1/80



Torque @ 25 MPa	2900 Nm
Nominal charge pressure	25 MPa , max. 28 MPa
Geometric displacement	830 ccm/rev
RPM range	0,5÷250 rev/min
Max. charge fluid temp.	70 °C
Charge fluid type	mineral oils, vegetable oils, water emulsion
Filtration	100 µm
Weight	46 kg
Options:	2-speed version (50:50), version with anti-shock valves built-in

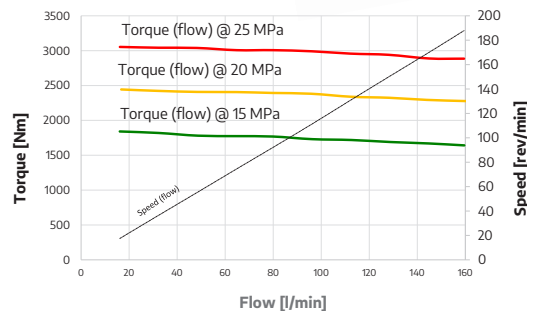

We have also in our offer a full range of P+SM type satellite motors in the range of displacement between 300 ccm/rev to 4700 ccm/rev.

SATELLITE MOTOR P+SM 2,1/80

MOTOR DESCRIPTION

Many years of experience allowed to develop a new generation of hydraulic motors, which, in addition to mining applications, will surely increase the range of applications required in the world wide industrial power hydraulics. The innovativeness and essence of these motors is, among other things, the possibility of running them instead of quality mineral oil, on other liquids with significantly lower viscosity and lubricity, i.e. vegetable oil or other such liquids.

Among the undoubted advantages of these motors are the increased resistance to contamination of the hydraulic fluid with particles.

Motors type P+SM can operate in potentially explosive environments



Our main goal is the functionality of the equipment and the high quality and durability of the products, which translates into low operating costs.

PRODUCTION AND SERVICE

PONAR Wadowice S.A.

ul. Wojska Polskiego 29
34-100 Wadowice
Poland

tel. +48 33 488 21 00
fax +48 33 488 21 03
e-mail: ponar@ponar-wadowice.pl
www.ponar-wadowice.pl

Export Department

tel. +48 33 488 28 20-29
fax +48 33 488 26 01

e-mail: export@ponar-wadowice.pl